

metrix[®]

ProbiX

Probes & accessories for SCOPIX oscilloscopes



- Active safety as soon as they are connected
- Quick, error-free measurements
- Scaling and units managed automatically
- Sensors powered directly by the oscilloscope



IEC 61010
Edition
2018

Measure up



PROBIX VOLTAGE MEASUREMENT

HIGH FREQUENCY

HX0130

Electronic voltage probe
1/10 – 500 MHz – 300 V Cat III

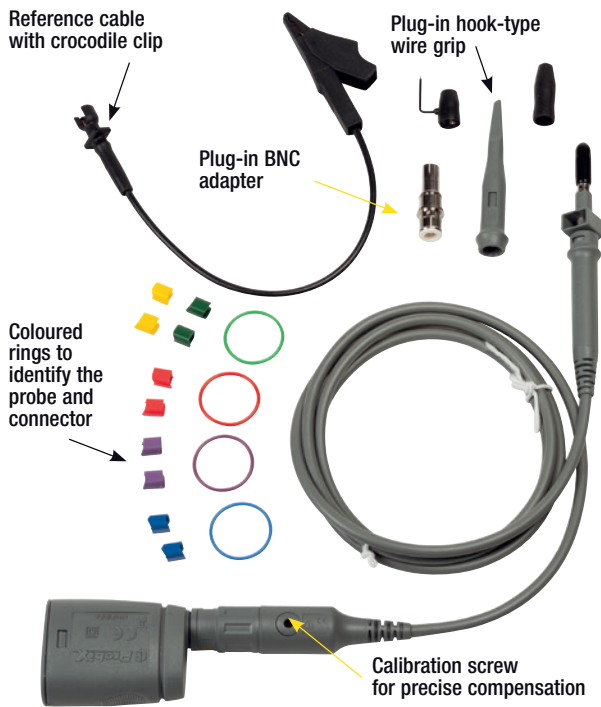

HX0030C

Voltage probe, 1/10 – 250 MHz
1000 V Cat II • 600 V Cat. III

The HX0030C probe offers direct reading of the measurement thanks to automatic scaling (no adjustments necessary on the **SCOPIX** analyser-oscilloscope). It is equipped with 2 configurable buttons for remote control of **SCOPIX**.

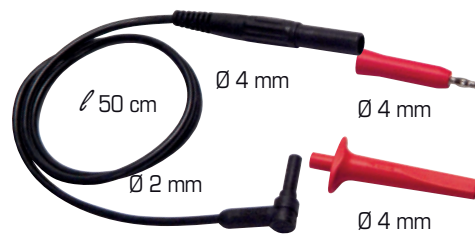
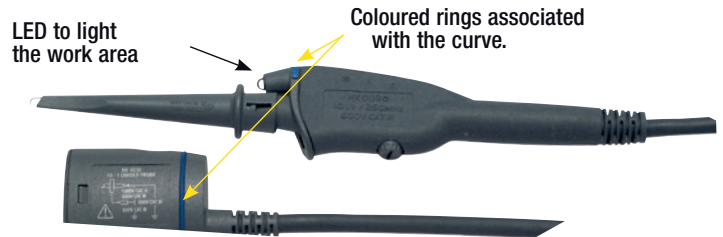

HX0071

Industrial accessories kit

This accessories kit is used with the HX0030B and HX0030C. For electrical / power electronics applications.

HX0032

Probix / BNC adapter, 50 Ω 30 V Cat. I
Bandwidth: 250 MHz, Max. power: 2 W for 50 Ω impedance adaptation or power measurement.



HX0031

Probix / BNC adapter, 300 MHz, 600 V Cat. III



LOW FREQUENCY

HX0033

Probix / banana adapter
200 kHz – 1/1 – 600 V Cat. III
Derating -20 dB/decade > 100 kHz



HX0093

Probix / banana adapter
300 Hz filter, 1/1,000 –
600 V Cat. III

The HX0093 is a third-order low-pass filter with the cut-off frequency set to 300 Hz. It can be used to isolate the 50 Hz or 60 Hz fundamental for measurements on PWM-controlled electric motors.



		Probe	BNC adapt.	Banana adapt.	Clamp
HX0130		✓			
HX0030C		✓			
HX0031			✓		
HX0032			✓ 50 Ω		
HX0033				✓	
HX0093				✓ < 300 Hz	
HX0034B					✓
HX0072					
HX0073					
HX0094				✓	
HX0035B					
HX0036					

PROBIX CURRENT MEASUREMENT

HX0034B

0.02 A – 60 Arms current clamp / 1 MHz / Input/output ratio 20 mV/A / Ø 26 mm

The HX0034 current clamp uses a Hall-effect cell and can measure alternating or direct currents up to 80 A peak, without any action on the electrical installation. Its internal electronics is powered by the oscilloscope via the connection cable. The measurement output is entirely isolated to ensure safety. It is equipped with 2 configurable buttons for remote control of **SCOPIX**. The DC offset is compensated automatically by pressing a button.



HX0072

AmpFlex® current sensor
5 A - 3 000 Arms / 200 kHz / Ø 240 mm

HX0072 is an AmpFlex® **ProbiX**, probe designed to measure AC currents up to 3,000 A RMS in the context of power distribution and machine testing.



HX0094

ProbiX 4-20 mA adapter
Input/output ratio 25 mV/A

The HX0094 with banana connector can be used for 4-20 mA current loop measurement by means of a built-in shunt. It is ideal for applications in the automation and process sectors.



HX0073

MiniAmpFlex® current probe, 1 A - 300 Arms / 3 MHz / Ø 35 mm

HX0073 is a MiniAmpFlex® **ProbiX**, probe used to measure AC currents up to 300 A RMS on switchboards or power electronics.



PROBIX TEMPERATURE MEASUREMENT



Model	HX0035B	HX0036
Measurement range	-40 °C to +1,250 °C	-100 °C to +500 °C
Accuracy	±1 %, ± 3.5 °C typ.	±1 %, ± 1.5 °C typ.
IEC 61010 electrical safety	30 V Cat. I	30 V Cat. I

HX0036

ProbiX / Pt100 probe adapter

HX0036 is a **ProbiX** adapter used to linearize temperature measurements from a Pt100 platinum probe. The ratio and the unit of measurement are managed automatically by **SCOPIX**.

HX0035B

ProbiX / K thermocouple

The HX0035B accessory is an adapter used to linearize temperature measurement from a K thermocouple (option). The ratio, cold junction compensation and unit are managed automatically by **SCOPIX**.



See all our K thermocouple and Pt100 temperature sensors at www.chauvin-arnoux.com

Connections				Measurement range as per IEC61010 Input in relation to the earth	Types of measurement
AmpFLEX clamp	MiniAmpFLEX SKI-20	SKI-19 sensors (1)	SPI0-13 sensors (2)		
				300 V CAT III	Voltage 1/10 500 MHz
				600 V CAT III	Voltage 1/10 250 MHz
				600 V CAT III	Voltage 250 MHz
				30 V CAT I	Voltage 250 MHz/2W
				600 V CAT III	Voltage Resistance Capacitance Tester 200 kHz
				600 V CAT III	Voltage Filter 300 Hz
				600 V CAT III	AC/DC current 60Arms 1 MHz
✓				600V CAT III	Current 5-300Arms 200 kHz AC
	✓			600V CAT III	Current 1-300Arms 3 MHz AC
				230VRMS max	4-20 mA % 25mV/mA
		✓			K thermocouple temp. from -10°C to +1250°C (1)
			✓		Pt100 probe temp. from 100°C to +500°C (2)

(1) Find all the SK thermocouples in the CHAUVIN ARNOUX range - (2) Find all the SP Pt100 sensors in the CHAUVIN ARNOUX range

PROBIX ACCESSORIES

ACCESSORIES FOR USE WITH			ProbiX	OTHER ACC
CMS banana cable	-	HX0064	HX0033	-
Industrial accessory kit	-	HX0071	HX0030B and C	-
µSD	-	OX9XXX	-	HX0179
USB---µSD - SD	-	OX9XXX/OX7XXX	-	HX0080
Demo test circuit		OX9XXX/OX7XXX	-	HX0074
50 Ω 600 V BNC/BNC cable	-	HX0106	HX0032	-
100mV* clamps	45A AC	MA200*	HX0031	-
-	60A AC	MN60*	HX0031	-
-	200A AC	C160*	HX0031	-

* Select the 100 mV/A range on the clamp for use with the HX0031.

HX0061

In-vehicle charger

The HX0061 can be used to power the **SCOPIX** from a vehicle battery. This accessory is connected to the standard power supply of the **SCOPIX**. It is ideal for travelling users, allowing them to recharge the instrument's battery in their vehicle between two series of measurements.



Max. input voltage	10 V _{DC} to 60 V _{DC}
Output voltage	120 VDC ± 5 V to 150 VDC ± 5 V
Power supplied	32 W max.
Protective fuses	2 fuses, 5 x 20 – 0.63 A – 250 VT
Reference standard	European Directive 2004/104/CE-2004

TRANSPORT ACCESSORIES

HX0038

Case for SCOPIX III with foam insert

HX0120

SCOPIX IV bag

This comprises an all-terrain **bag with waterproof underside**, shoulder strap (380x280x200mm) and an **inner bag** with compartments to stow your SCOPIX and its accessories.



MISCELLANEOUS ACCESSORIES FOR SCOPIX IV

HX0179

HC-type µSD card (storage capacity: please contact us)

Removable digital data storage memory card

The HX0080 µSD /USB card reader is also delivered with the HX0179.

HX0121

Stylus kit

This kit comprises 5 spare styluses for use on the SCOPIX IV touch screen.

P01102155

40 W mains power pack/charger

Mains power pack, LI-ION battery and charger support.

P01102130

External charger for LI-ION battery

This accessory allows you to charge a second battery.

MISCELLANEOUS ACCESSORIES FOR SCOPIX IV

HX0130.....Electronic voltage probe, 1/10 - 500 MHz

HX0030C.....Voltage probe, 1/10 - 250 MHz

HX0031.....Probix / BNC adapter

HX0032.....Probix / BNC 50 Ω adapter

HX0033.....Probix / banana adapter

HX0034B.....Current clamp, 0.02 A - 60 A / 1 MHz

HX0035B.....Probix / K thermocouple adapter

HX0036.....Probix / Pt100 probe adapter

HX0038.....Case for SCOPIX III

HX0061.....10-60 VDC in-vehicle charger

HX0071.....Industrial accessories kit for HX0030B and HX0030C probes

HX0072.....AmpFlex® current probe, 5 A – 3,000 A / 200 kHz

HX0073.....MiniAmpFlex® current probe, 1 A - 300 A / 3 MHz

HX0093.....Probix / banana, 300 Hz filter

HX0094.....Probix 4-20 mA adapter

HX0120.....Bag for SCOPIX IV



Don't forget to update your Scopix on our support website.



FRANCE
Chauvin Arnoux
 12-16 rue Sarah Bernhardt
 92600 Asnières-sur-Seine
 Tél : +33 1 44 85 44 85
 Fax : +33 1 46 27 95 59
 export@chauvin-arnoux.fr
 www.chauvin-arnoux.com

UNITED KINGDOM
Chauvin Arnoux Ltd
 Unit 1 Nelson Ct, Flagship Sq, Shaw Cross Business Pk
 Dewsbury, West Yorkshire - WF12 7TH
 Tel: +44 1924 460 494
 Fax: +44 1924 455 328
 info@chauvin-arnoux.co.uk
 www.chauvin-arnoux.com

MIDDLE EAST
Chauvin Arnoux Middle East
 P.O. BOX 60-154
 1241 2020 JAL EL DIB - LEBANON
 Tel: +961 1 890 425
 Fax: +961 1 890 424
 camie@chauvin-arnoux.com
 www.chauvin-arnoux.com

Information and Ordering